

# OTM HOLESHOT® DRILLS

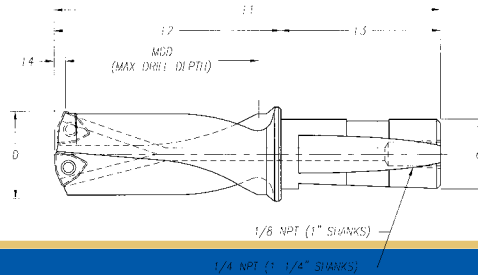

Holeshot® Drills								INCH / METRIC			
Part Number	D	d	MDD	L1	L2	L3	L4	Insert	Qty.	Screw	Wrench
DR-0515-X3N	0.515	0.750	1.54	4.23	2.20	2.03	0.070	WCMX S30204-M1A	2	SCR-07	T6
DR-0531-X3N	0.531	0.750	1.59	4.29	2.26	2.03	0.072				
DR-0551-X3N	0.551 (14 mm)	0.750	1.65	4.43	2.40	2.03	0.074				
DR-0563-X3N	0.563	0.750	1.70	4.36	2.33	2.03	0.079				
DR-0591-X3N	0.591 (15 mm)	0.750	1.77	4.55	2.52	2.03	0.083				
DR-0594-X3N	0.594	0.750	1.78	4.49	2.46	2.03	0.083				
DR-0625-X3N	0.625	0.750	1.87	4.62	2.59	2.03	0.087				
DR-0630-X3N	0.630 (16 mm)	0.750	1.89	4.68	2.65	2.03	0.088				
DR-0656-X3N	0.656	0.750	1.96	4.75	2.72	2.03	0.091				
DR-0669-X3N	0.669 (17 mm)	0.750	2.01	4.80	2.77	2.03	0.093				
DR-0688-X3N	0.688	0.750	2.06	4.87	2.84	2.03	0.090	WCMX 040204-M1A	2	SCR-01	T7
DR-0709-X3N	0.709 (18 mm)	0.750	2.13	5.04	3.01	2.03	0.092				
DR-0719-X3N	0.719	0.750	2.15	5.00	2.97	2.03	0.093				
DR-0750-X3N	0.750	0.750	2.25	5.13	3.10	2.03	0.102				
DR-0781-X3N	0.781	0.750	2.34	5.26	3.23	2.03	0.106				
DR-0787-X3N	0.787 (20 mm)	0.750	2.36	5.29	3.26	2.03	0.106				
DR-0813-X3N	0.813	0.750	2.44	5.39	3.36	2.03	0.110				
DR-0827-X3N	0.827 (21 mm)	0.750	2.48	5.41	3.38	2.03	0.112				
DR-0844-X3N	0.844	0.750	2.53	5.52	3.49	2.03	0.114				
DR-0866-X3N	0.866 (22 mm)	1.000	2.60	5.80	3.52	2.28	0.130				
DR-0875	0.875	1.000	1.75	4.78	2.50	2.28	0.131				
DR-0875-X3N	0.875	1.000	2.63	5.79	3.51	2.28	0.131				
DR-0906	0.906 (23 mm)	1.000	1.75	4.78	2.50	2.28	0.135				
DR-0906-X3N	0.906 (23 mm)	1.000	2.71	5.88	3.60	2.28	0.135				
DR-0937	0.937	1.000	1.75	4.78	2.50	2.28	0.139				
DR-0937-X3N	0.937	1.000	2.81	5.98	3.70	2.28	0.139				
DR-0945	0.945 (24 mm)	1.000	1.75	4.78	2.50	2.28	0.140				
DR-0945-X3N	0.945	1.000	2.83	6.04	3.76	2.28	0.140				
DR-0969	0.969	1.000	1.75	4.78	2.50	2.28	0.143				
DR-0969-X3N	0.969	1.000	2.91	6.08	3.80	2.28	0.143	WCMX 050308-M1(A) or WCGT 050308-M1	2	SCR-03	T9
DR-0984	.984 (25 mm)	1.000	1.75	4.78	2.50	2.28	0.145				
DR-0984-X3N	0.984 (25 mm)	1.000	2.95	6.17	3.89	2.28	0.145				
DR-1000	1.000	1.000	1.75	4.78	2.50	2.28	0.147				
DR-1000-X3N	1.000	1.000	3.00	6.18	3.90	2.28	0.147				
DR-1024	1.024 (26 mm)	1.000	1.75	4.78	2.50	2.28	0.150				
DR-1024-X3N	1.024 (26 mm)	1.000	3.07	6.29	4.01	2.28	0.150				
DR-1031	1.031	1.000	2.13	5.16	2.88	2.28	0.151				
DR-1031-X3N	1.031	1.000	3.09	6.27	3.99	2.28	0.151				
DR-1062	1.062 (27 mm)	1.000	2.13	5.16	2.88	2.28	0.155				

See page 12 for Insert Specifications and Grade Selection.

# OTM HOLESHOT® DRILLS

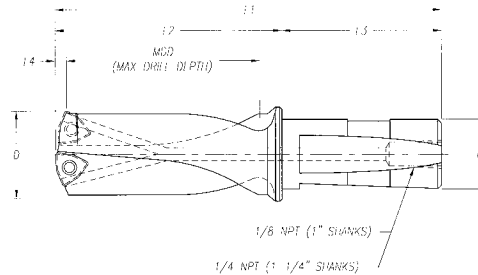

Holeshot® Drills								INCH / METRIC			
Part Number	D	d	MDD	L1	L2	L3	L4	Insert	Qty.	Screw	Wrench
DR-1062-X3N	1.062 (27 mm)	1.000	3.18	6.37	4.09	2.28	0.155	WCMX 050308-M1(A) or WCGT 050308-M1	2	SCR-03	T9
DR-1094	1.094	1.000	2.13	5.16	2.88	2.28	0.159				
DR-1094-X3N	1.094	1.000	3.28	6.47	4.19	2.28	0.159				
DR-1102	1.102 (28 mm)	1.000	2.13	5.16	2.88	2.28	0.160				
DR-1102-X3N	1.102 (28 mm)	1.000	3.31	6.53	4.25	2.28	0.160				
DR-1125	1.125	1.000	2.13	5.16	2.88	2.28	0.163				
DR-1125-X3N	1.125	1.000	3.37	6.56	4.28	2.28	0.163				
DR-1142	1.142 (29 mm)	1.000	2.13	5.16	2.88	2.28	0.165				
DR-1142-X3N	1.142 (29 mm)	1.000	3.43	6.66	4.38	2.28	0.165				
DR-1156	1.156	1.000	2.13	5.16	2.88	2.28	0.167				
DR-1156-X3N	1.156	1.000	3.47	6.67	4.39	2.28	0.167				
DR-1181	1.181 (30 mm)	1.000	2.13	5.16	2.88	2.28	0.169	WCMX 06T308-M1(A) or WCGT 06T308-M1	2	SCR-30	T10
DR-1181-X3N	1.181 (30 mm)	1.250	3.54	6.78	4.50	2.28	0.169				
DR-1187	1.187	1.000	2.13	5.16	2.88	2.28	0.169				
DR-1187-X3N	1.187	1.250	3.56	6.76	4.48	2.28	0.169				
DR-1219	1.219	1.000	2.50	5.53	3.25	2.28	0.173				
DR-1219-X3N	1.219	1.250	3.66	6.86	4.58	2.28	0.173				
DR-1250	1.250	1.000	2.50	5.53	3.25	2.28	0.177				
DR-1250-X3N	1.250	1.250	3.75	6.96	4.68	2.28	0.177				
DR-1260	1.260 (32 mm)	1.000	2.50	5.53	3.25	2.28	0.179				
DR-1260-X3N	1.260 (32 mm)	1.250	3.78	7.03	4.75	2.28	0.179				
DR-1281	1.281	1.000	2.50	5.53	3.25	2.28	0.181	WCMX 06T308-M1(A) or WCGT 06T308-M1	2	SCR-30	T10
DR-1281-X3N	1.281	1.250	3.84	7.05	4.77	2.28	0.181				
DR-1299	1.299 (33 mm)	1.000	2.50	5.53	3.25	2.28	0.184				
DR-1299-X3N	1.299 (33 mm)	1.250	3.90	7.15	4.87	2.28	0.184				
DR-1312	1.312	1.000	2.50	5.53	3.25	2.28	0.185				
DR-1312-X3N	1.312	1.250	3.94	7.16	4.88	2.28	0.185				
DR-1339	1.339 (34 mm)	1.000	2.50	5.53	3.25	2.28	0.189				
DR-1339-X3N	1.339 (34 mm)	1.250	4.02	7.27	4.99	2.28	0.189				
DR-1344	1.344	1.000	2.50	5.53	3.25	2.28	0.190				
DR-1344-X3N	1.344	1.250	4.03	7.25	4.97	2.28	0.190				
DR-1375	1.375	1.000	2.50	5.53	3.25	2.28	0.193	WCMX 06T308-M1(A) or WCGT 06T308-M1	2	SCR-30	T10
DR-1375-X3N	1.375	1.250	4.12	7.34	5.06	2.28	0.193				
DR-1406	1.406	1.000	2.75	5.78	3.50	2.28	0.197				
DR-1406-X3N	1.406	1.250	4.22	7.45	5.17	2.28	0.197				
DR-1417	1.417 (36 mm)	1.000	2.75	5.78	3.50	2.28	0.199				
DR-1417-X3N	1.417 (36 mm)	1.250	4.25	7.52	5.24	2.28	0.199				
DR-1437	1.437	1.000	2.75	5.78	3.50	2.28	0.196				
DR-1437-X3N	1.437	1.250	4.31	7.54	5.26	2.28	0.196				
DR-1457	1.457 (37 mm)	1.000	2.75	5.78	3.50	2.28	0.199				
DR-1457-X3N	1.457 (37 mm)	1.250	4.37	7.64	5.36	2.28	0.199				
DR-1469	1.469	1.000	2.75	5.78	3.50	2.28	0.200	WCMX 06T308-M1(A) or WCGT 06T308-M1	2	SCR-30	T10
DR-1469-X3N	1.469	1.250	4.40	7.63	5.35	2.28	0.200				

See page 12 for Insert Specifications and Grade Selection.

# OTM HOLESHOT® DRILLS

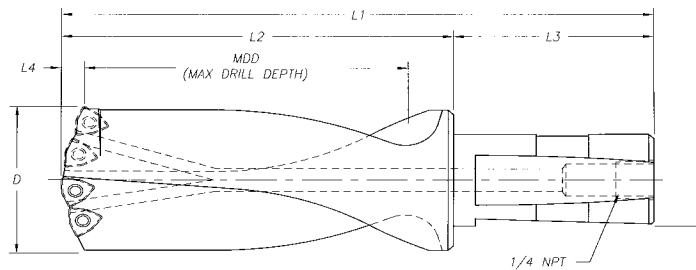

HoleShot® Drills								INCH / METRIC			
Part Number	D	d	MDD	L1	L2	L3	L4	Insert	Qty.	Screw	Wrench
DR-1496	1.496 (38 mm)	1.000	2.75	5.78	3.50	2.28	0.204	WCMX 06T308-M1(A) or WCGT 06T308-M1	2	SCR-30	T10
DR-1496-X3N	1.496 (38 mm)	1.250	4.49	7.76	5.48	2.28	0.204				
DR-1500	1.500	1.000	2.75	5.78	3.50	2.28	0.204				
DR-1500-X3N	1.500	1.250	4.50	7.73	5.45	2.28	0.204				
DR-1531	1.531	1.250	2.88	6.16	3.88	2.28	0.208				
DR-1531-X3N	1.531	1.250	4.59	8.08	5.80	2.28	0.208				
DR-1535	1.535 (39 mm)	1.250	2.88	6.16	3.88	2.28	0.209				
DR-1535-X3N	1.535 (39 mm)	1.250	4.61	8.08	5.80	2.28	0.209				
DR-1562	1.562	1.250	2.88	6.16	3.88	2.28	0.212				
DR-1562-X3N	1.562	1.250	4.68	8.17	5.89	2.28	0.212				
DR-1575	1.575 (40 mm)	1.250	2.88	6.16	3.88	2.28	0.208				
DR-1575-X3N	1.575 (40 mm)	1.500	4.72	8.61	5.92	2.69	0.208				
DR-15941	.594	1.250	2.88	6.16	3.88	2.28	0.210				
DR-1594-X3N	1.594	1.500	4.78	8.68	5.99	2.69	0.210				
DR-1614	1.614 (41 mm)	1.250	2.88	6.16	3.88	2.28	0.212				
DR-1614-X3N	1.614 (41 mm)	1.500	4.84	8.73	6.04	2.69	0.212				
DR-1625	1.625	1.250	2.88	6.16	3.88	2.28	0.214				
DR-1625-X3N	1.625	1.500	4.87	8.77	6.08	2.69	0.214				
DR-16561	.656	1.250	2.88	6.16	3.88	2.28	0.218				
DR-1656-X3N	1.656	1.500	4.96	8.87	6.18	2.69	0.218				
DR-1687	1.687	1.250	2.88	6.16	3.88	2.28	0.221				
DR-1687-X3N	1.687	1.500	5.06	8.97	6.28	2.69	0.221				
DR-1693	1.693 (43 mm)	1.250	2.88	6.16	3.88	2.28	0.222				
DR-1693-X3N	1.693 (43 mm)	1.500	5.08	8.97	6.28	2.69	0.222				
DR-1719	1.719	1.250	3.00	6.41	4.13	2.28	0.225				
DR-1719-X3N	1.719	1.500	5.15	9.20	6.51	2.69	0.225				
DR-1732	1.732 (44 mm)	1.250	3.00	6.41	4.13	2.28	0.224				
DR-1732-X3N	1.732 (44 mm)	1.500	5.20	9.29	6.60	2.69	0.224				
DR-1750	1.750	1.250	3.00	6.41	4.13	2.28	0.225				
DR-1750-X3N	1.750	1.500	5.25	9.30	6.61	2.69	0.225				
DR-1772	1.772 (45 mm)	1.250	3.00	6.41	4.13	2.28	0.231				
DR-1772-X3N	1.772 (45 mm)	1.500	5.31	9.42	6.73	2.69	0.231				
DR-1781	1.781	1.250	3.00	6.41	4.13	2.28	0.223				
DR-1781-X3N	1.781	1.500	5.34	9.38	6.69	2.69	0.223				
DR-1812	1.812	1.250	3.00	6.41	4.13	2.28	0.230				
DR-1812-X3N	1.812	1.500	5.43	9.48	6.79	2.69	0.230				
DR-1844	1.844	1.250	3.38	6.78	4.50	2.28	0.233				
DR-1844-X3N	1.844	1.500	5.53	9.58	6.89	2.69	0.233				
DR-1850	1.850 (47 mm)	1.250	3.38	6.78	4.50	2.28	0.233				
DR-1850-X3N	1.850 (47 mm)	1.500	5.55	9.66	6.97	2.69	0.233				

See page 12 for Insert Specifications and Grade Selection.

# OTM HOLESHOT® DRILLS

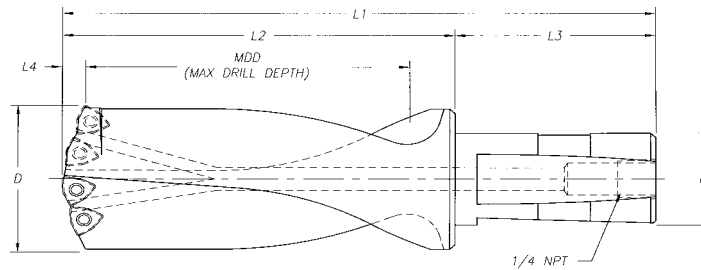

Holeshot® Drills								INCH / METRIC			
Part Number	D	d	MDD	L1	L2	L3	L4	Insert	Qty.	Screw	Wrench
DR-1875	1.875	1.250	3.38	6.78	4.50	2.28	0.240	WCMX 050308-M1(A) or WCGT 050308-M1	4	SCR-03	T9
DR-1875-X3N	1.875	1.500	5.62	9.68	6.99	2.69	0.240				
DR-1890	1.890 (48 mm)	1.250	3.38	6.78	4.50	2.28	0.245				
DR-1890-X3N	1.890 (48 mm)	1.500	5.67	9.79	7.10	2.69	0.245				
DR-1906	1.906	1.250	3.38	6.78	4.50	2.28	0.254				
DR-1906-X3N	1.906	1.500	5.72	9.79	7.10	2.69	0.254				
DR-1929	1.929 (49 mm)	1.250	3.38	6.78	4.50	2.28	0.259				
DR-1929-X3N	1.929 (49 mm)	1.500	5.79	9.92	7.23	2.69	0.259				
DR-1937	1.937	1.250	3.38	6.78	4.50	2.28	0.259				
DR-1937-X3N	1.937	1.500	5.81	9.89	7.20	2.69	0.259				
DR-1969	1.969 (50 MM)	1.250	3.38	6.78	4.50	2.28	0.260	WCMX 050308-M1(A) or WCGT 050308-M1	4	SCR-03	T9
DR-1969-X3N	1.969 (50 MM)	1.500	5.91	9.99	7.30	2.69	0.260				
DR-2000-X1	2.000	1.250	2.13	6.06	3.38	2.28	0.267				
DR-2000	2.000	1.250	3.38	6.78	4.50	2.28	0.267				
DR-2000-X3N	2.000	1.500	6.00	10.09	7.40	2.69	0.267				
DR-2008	2.008 (51 mm)	1.250	3.38	6.78	4.50	2.28	0.267				
DR-2008-X3N	2.008 (51 mm)	1.500	6.02	10.16	7.47	2.69	0.267				
DR-2031-X1	2.031	1.500	2.13	6.06	3.38	2.69	0.268				
DR-2031	2.031	1.500	3.50	7.44	4.75	2.69	0.268				
DR-2031-X3N	2.031	1.500	6.09	10.30	7.61	2.69	0.268				
DR-2047	2.047 (52 mm)	1.500	3.50	7.44	4.75	2.69	0.259	WCMX 06T308-M1(A) or WCGT 06T308-M1	4	SCR-30	T10
DR-2047-X3N	2.047 (52 mm)	2.000	6.14	10.91	7.66	3.25	0.259				
DR-2062-X1	2.062	1.500	2.13	6.06	3.38	2.69	0.260				
DR-2062	2.062	1.500	3.50	7.44	4.75	2.69	0.260				
DR-2062-X3N	2.062	2.000	6.18	10.94	7.69	3.25	0.260				
DR-2087	2.087 (53 mm)	1.500	3.50	7.44	4.75	2.69	0.267				
DR-2087-X3N	2.087 (53 mm)	2.000	6.26	11.04	7.79	3.25	0.267				
DR-2094-X1	2.094	1.500	2.13	6.06	3.38	2.69	0.267				
DR-2094	2.094	1.500	3.50	7.44	4.75	2.69	0.267				
DR-2094-X3N	2.094	2.000	6.28	11.05	7.80	3.25	0.267				
DR-2125-X1	2.125 (54 MM)	1.500	2.13	6.06	3.38	2.69	0.266	WCMX 06T308-M1(A) or WCGT 06T308-M1	4	SCR-30	T10
DR-2125	2.125 (54 MM)	1.500	3.50	7.44	4.75	2.69	0.266				
DR-2125-X3N	2.125	2.000	6.37	11.14	7.89	3.25	0.266				
DR-2156-X1	2.156	1.500	2.31	6.25	3.56	2.69	0.270				
DR-2156	2.156	1.500	3.88	7.81	5.13	2.69	0.270				
DR-2156-X3N	2.156	2.000	6.47	11.24	7.99	3.25	0.270				
DR-2165	2.165 (55 mm)	1.500	3.88	7.81	5.13	2.69	0.273				
DR-2165-X3N	2.165 (55 mm)	2.000	6.50	11.28	8.03	3.25	0.273				
DR-2187-X1	2.187	1.500	2.31	6.25	3.56	2.69	0.273				
DR-2187	2.187	1.500	3.88	7.81	5.13	2.69	0.273				

See page 12 for Insert Specifications and Grade Selection.

# OTM HOLESHOT® DRILLS

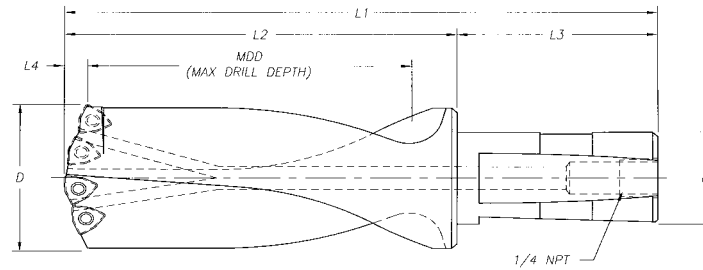

Holeshot® Drills								INCH / METRIC			
Part Number	D	d	MDD	L1	L2	L3	L4	Insert	Qty.	Screw	Wrench
DR-2187-X3N	2.187	2.000	6.56	11.33	8.08	3.25	0.273	WCMX 06T308-M1(A) or WCGT 06T308-M1	4	SCR-30	T10
DR-2205	2.205 (56 mm)	1.500	3.88	7.81	5.13	2.69	0.283				
DR-2205-X3N	2.205 (56 mm)	2.000	6.61	11.41	8.16	3.25	0.283				
DR-2219-X1	2.219	1.500	2.31	6.25	3.56	2.69	0.277				
DR-2219	2.219	1.500	3.88	7.81	5.13	2.69	0.277				
DR-2219-X3N	2.219	2.000	6.66	11.44	8.19	3.25	0.277				
DR-2244	2.244 (57 mm)	1.500	3.88	7.81	5.13	2.69	0.281				
DR-2244-X3N	2.244 (57 mm)	2.000	6.73	11.52	8.27	3.25	0.281				
DR-2250-X1	2.250	1.500	2.31	6.25	3.56	2.69	0.281				
DR-2250	2.250	1.500	3.88	7.81	5.13	2.69	0.281				
DR-2250-X3N	2.250	2.000	6.75	11.53	8.28	3.25	0.281				
DR2281-X1	2.281	1.500	2.31	6.25	3.56	2.69	0.283				
DR-2281	2.281	1.500	3.88	7.81	5.13	2.69	0.283				
DR-2281-X3N	2.281	2.000	6.84	11.62	8.37	3.25	0.283				
DR-2312-X1	2.312	1.500	2.31	6.25	3.56	2.69	0.287				
DR-2312	2.312	1.500	3.88	7.81	5.13	2.69	0.287				
DR-2312-X3N	2.312	2.000	6.93	11.72	8.47	3.25	0.287				
DR-2323	2.323 (59 mm)	1.500	3.88	7.81	5.13	2.69	0.290				
DR-2323-X3N	2.323 (59 mm)	2.000	6.97	11.77	8.52	3.25	0.290				
DR-2344-X1	2.344	1.500	2.50	6.56	3.88	2.69	0.289				
DR-2344	2.344	1.500	4.13	8.19	5.50	2.69	0.289				
DR-2344-X3N	2.344	2.000	7.03	11.95	8.70	3.25	0.289				
DR-2362	2.362 (60 mm)	1.500	4.13	8.19	5.50	2.69	0.301				
DR-2362-X3N	2.362 (60 mm)	2.000	7.09	12.02	8.77	3.25	0.301				
DR-2375-X1	2.375	1.500	2.50	6.56	3.88	2.69	0.298				
DR-2375	2.375	1.500	4.13	8.19	5.50	2.69	0.298				
DR-2375-X3N	2.375	2.000	7.12	12.05	8.80	3.25	0.298				
DR-2402	2.402 (61 mm)	1.500	4.13	8.19	5.50	2.69	0.304				
DR-2402-X3N	2.402 (61 mm)	2.000	7.20	12.14	8.89	3.25	0.304				
DR-2406-X1	2.406	1.500	2.50	6.56	3.88	2.69	0.304				
DR-2406	2.406	1.500	4.13	8.19	5.50	2.69	0.304				
DR-2406-X3N	2.406	2.000	7.22	12.15	8.90	3.25	0.304				
DR-2437-X1	2.437	1.500	2.50	6.56	3.88	2.69	0.309				
DR-2437	2.437	1.500	4.13	8.19	5.50	2.69	0.309				
DR-2437-X3N	2.437	2.000	7.31	12.25	9.00	3.25	0.309				
DR-2441	2.441 (62 mm)	1.500	4.13	8.19	5.50	2.69	0.309				
DR-2441-X3N	2.441 (62 mm)	2.000	7.32	12.26	9.01	3.25	0.309				
DR-2469-X1	2.469	1.500	2.50	6.56	3.88	2.69	0.319				
DR-2469	2.469	1.500	4.13	8.19	5.50	2.69	0.319				
DR-2469-X3N	2.469	2.000	7.41	12.36	9.11	3.25	0.319				

See page 12 for Insert Specifications and Grade Selection.

# OTM HOLESHOT® DRILLS

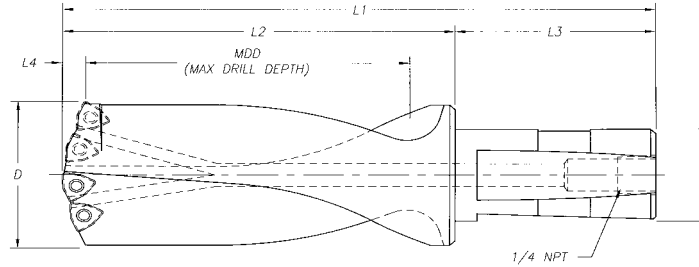

Holeshot® Drills								INCH / METRIC			
Part Number	D	d	MDD	L1	L2	L3	L4	Insert	Qty.	Screw	Wrench
DR-2480	2.480 (63 mm)	1.500	4.13	8.19	5.50	2.69	0.310	WCMX 06T308-M1(A) or WCGT 06T308-M1	4	SCR-30	T10
DR-2480-X3N	2.480 (63 mm)	2.000	7.44	12.38	9.13	3.25	0.310				
DR-2500-X1	2.500	1.500	2.50	6.56	3.88	2.69	0.329				
DR-2500	2.500	1.500	4.13	8.19	5.50	2.69	0.329				
DR-2500-X3N	2.500	2.000	7.50	12.46	9.21	3.25	0.329				
DR-2625-X1	2.625	2.000	2.75	7.50	4.25	3.25	0.326				
DR-2625	2.625	2.000	6.50	11.25	8.00	3.25	0.326				
DR-2750-X1	2.750	2.000	2.75	7.50	4.25	3.25	0.340				
DR-2750	2.750	2.000	6.50	11.25	8.00	3.25	0.340				
DR-2875-X1	2.875	2.000	3.00	7.75	4.50	3.25	0.357				
DR-2875	2.875	2.000	6.50	11.25	8.00	3.25	0.357				
DR-3000-X1	3.000	2.000	3.00	7.75	4.50	3.25	0.369	WCMX 06T308-M1(A) or WCGT 06T308-M1	6	SCR-30	T10
DR-3000	3.000	2.000	6.50	11.25	8.00	3.25	0.369				
DR-3125-X1	3.125	2.000	3.25	8.13	4.88	3.25	0.393				
DR-3125	3.125	2.000	7.63	12.50	9.25	3.25	0.393				
DR-3250-X1	3.250	2.000	3.25	8.13	4.88	3.25	0.387				
DR-3250	3.250	2.000	7.63	12.50	9.25	3.25	0.387				
DR-3375-X1	3.375	2.000	3.50	8.38	5.13	3.25	0.393				
DR-3375	3.375	2.000	7.63	12.50	9.25	3.25	0.393				
DR-3500-X1	3.500	2.000	3.50	8.38	5.13	3.25	0.440				
DR-3500	3.500	2.000	7.63	12.50	9.25	3.25	0.440				
DR-3625-X1	3.625	2.000	3.75	8.75	5.50	3.25	0.441	WCMX 06T308-M1(A) or WCGT 06T308-M1	6	SCR-30	T10
DR-3625	3.625	2.000	7.94	12.67	9.42	3.25	0.441				
DR-3750-X1	3.750	2.000	3.75	8.75	5.50	3.25	0.459				
DR-3750	3.750	2.000	8.00	13.00	9.75	3.25	0.459				
DR-3875-X1	3.875	2.000	4.00	9.38	6.13	3.25	0.470				
DR-3875	3.875	2.000	8.44	13.44	10.19	3.25	0.470				
DR-4000-X1	4.000	2.000	4.00	9.38	6.13	3.25	0.482				
DR-4000	4.000	2.000	8.56	13.88	10.63	3.25	0.482				

See page 12 for Insert Specifications and Grade Selection.



## OTM COREMASTER™ COREDRILLS Fixed Pocket



## OTM COREMASTER™ COREDRILLS Adjustable Cartridge

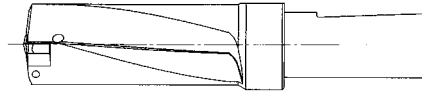
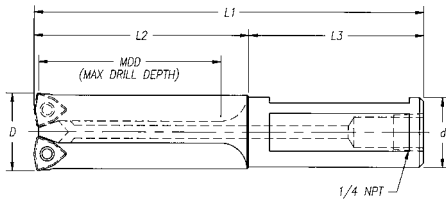

Coremaster™ Coredrills – Fixed Pocket									INCH		
Part Number	D	d	d2	MDD	L1	L2	L3	Insert (2)	Screw	Wrench	
CD-0825	.825	1.000	N/A	1.750	4.750	2.250	2.500	WCMX 050308-M1(A) or WCGT 050308-M1	SCR-03	T9	
CD-0865	.865	1.000	N/A	1.750	4.750	2.250	2.500		SCR-03	T9	
CD-0938	.938	1.000	N/A	1.750	4.750	2.250	2.500		SCR-03	T9	
CD-0990	.990	1.000	N/A	2.000	5.000	2.500	2.500	WCMX 050308-M1(A) or WCGT 050308-M1	SCR-03	T9	
CD-1052	1.052	1.000	N/A	2.000	5.000	2.500	2.500		SCR-03	T9	
CD-1115	1.115	1.000	N/A	2.500	5.500	3.000	2.500		SCR-30	T10	
CD-1178	1.178	1.000	N/A	2.500	5.500	3.000	2.500	WCMX 050308-M1(A) or WCGT 050308-M1	SCR-30	T10	
CD-1240	1.240	1.000	N/A	2.500	5.500	3.000	2.500		SCR-30	T10	
CD-1303	1.303	1.000	N/A	2.500	5.500	3.000	2.500		SCR-30	T10	

\*Maximum material removal: WCMX 050308 – 5/16" per side, WCMX 06T308 – 3/8" per side.  
See page 12 for Insert Specifications and Grade Selection.

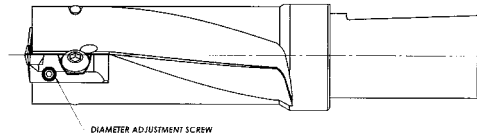
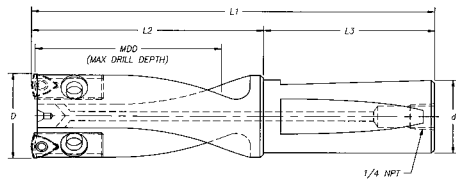
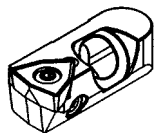

Coremaster™ Coredrills – Adjustable Cartridge										INCH			
Part Number	D	d	d2	MDD	L1	L2	L3	Insert (2)	Screw	Wrench	Cartridge	Screw	
CD-1360-C	1.36-1.46	1.250	N/A	2.750	6.250	3.500	2.750	WCMX 06T308-M1(A) or WCGT 06T308-M1	SCR-30	T10	02-03	01-01	
CD-1460-C	1.46-1.56	1.250	N/A	2.750	6.250	3.500	2.750		SCR-30	T10	02-03	01-01	
CD-1560-C	1.56-1.66	1.250	N/A	2.750	6.250	3.500	2.750		SCR-30	T10	02-03	01-01	
CD-1660-C	1.66-1.76	1.250	N/A	2.750	6.250	3.500	2.750		SCR-30	T10	02-03	01-02	
CD-1760-C	1.76-1.86	1.500	N/A	3.125	7.000	4.000	3.000		SCR-30	T10	02-03	01-02	
CD-1860-C	1.86-1.96	1.500	N/A	3.125	7.000	4.000	3.000		SCR-30	T10	02-03	01-02	
CD-1960-C	1.96-2.06	1.500	N/A	3.125	7.000	4.000	3.000		SCR-30	T10	02-03	01-02	
CD-2060-C	2.06-2.16	1.500	N/A	3.125	7.000	4.000	3.000		SCR-30	T10	02-03	01-02	
CD-2160-C	2.16-2.26	1.500	N/A	3.125	7.000	4.000	3.000		SCR-30	T10	02-03	01-02	
CD-2260-C	2.26-2.36	1.500	N/A	3.125	7.000	4.000	3.000		SCR-30	T10	02-03	01-02	
CD-2360-C	2.36-2.46	1.500	N/A	3.125	7.000	4.000	3.000		SCR-30	T10	02-03	01-02	
CD-2460-C	2.46-2.56	1.500	N/A	3.125	7.000	4.000	3.000		SCR-30	T10	02-03	01-02	
CD-2560-C	2.56-2.66	1.500	N/A	3.125	7.000	4.000	3.000		SCR-30	T10	02-03	01-02	
CD-2660-C	2.66-2.76	1.500	N/A	3.125	7.000	4.000	3.000		SCR-30	T10	02-03	01-02	
CD-2760-C	2.76-2.86	1.500	N/A	3.125	7.000	4.000	3.000		SCR-30	T10	02-03	01-02	
CD-2860-C	2.86-2.96	1.500	N/A	3.125	7.000	4.000	3.000		SCR-30	T10	02-03	01-02	
CD-2960-C	2.96-3.06	1.500	N/A	3.125	7.000	4.000	3.000		SCR-30	T10	02-03	01-02	

\*Maximum material removal: WCMX 050308 – 5/16" per side, WCMX 06T308 – 3/8" per side.  
Cartridges can be adjusted 0.075" per side, providing 0.150" adjustment capability on diameter.  
See page 12 for Insert Specifications and Grade Selection.

# OTM COREMASTER™ COREDRILLS XL

## Fixed Pocket



# OTM COREMASTER™ COREDRILLS XL

## Adjustable Cartridge

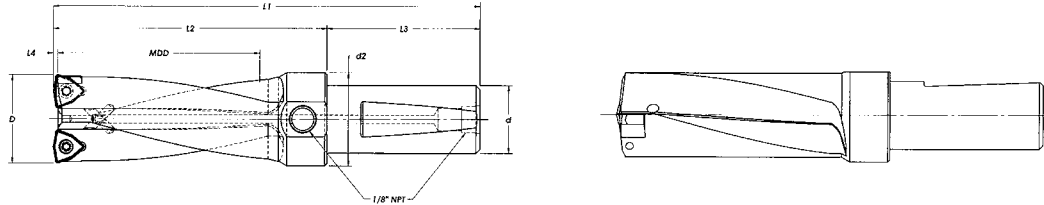

Coremaster™ Coredrills XL – Fixed Pocket										INCH	
Part Number	D	d	d2	MDD	L1	L2	L3	Insert (2)	Screw	Wrench	
CD-0825-XL	0.825	1.000	1.375	2.250	5.530	3.250	2.280	WCMX 050308-M1(A) or WCGT 050308-M1	SCR-03	T9	
CD-0865-XL	0.865	1.000	1.375	2.250	5.530	3.250	2.280		SCR-03	T9	
CD-0938-XL	0.938	1.000	1.375	2.500	5.780	3.500	2.280		SCR-03	T9	
CD-0990-XL	0.990	1.000	1.375	2.500	5.780	3.500	2.280		SCR-03	T9	
CD-1052-XL	1.052	1.000	1.375	2.500	5.780	3.500	2.280	WCMX 050308-M1(A) or WCGT 050308-M1	SCR-03	T9	
CD-1115-XL	1.115	1.000	1.375	3.000	6.280	4.000	2.280		SCR-30	T10	
CD-1178-XL	1.178	1.000	1.375	3.000	6.280	4.000	2.280		SCR-30	T10	
CD-1240-XL	1.240	1.000	1.375	3.000	6.280	4.000	2.280		SCR-30	T10	
CD-1303-XL	1.303	1.000	1.375	3.000	6.280	4.000	2.280	SCR-30	T10		

\*Maximum material removal: WCMX 050308 – 5/16" per side, WCMX 06T308 – 3/8" per side.  
See page 12 for Insert Specifications and Grade Selection.

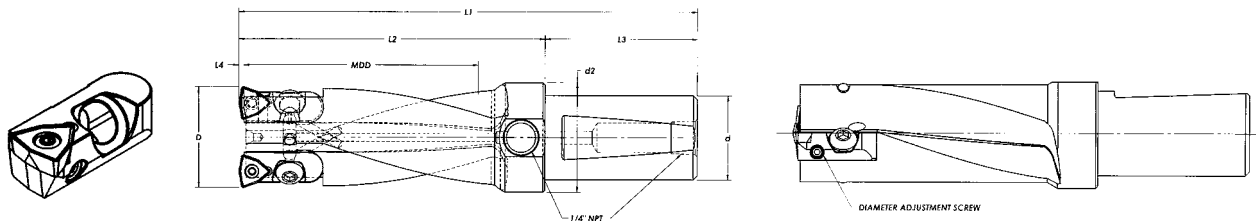

Coremaster™ Coredrills XL – Adjustable Cartridge											INCH	
Part Number	D	d	d2	MDD	L1	L2	L3	Insert (2)	Screw	Wrench	Cartridge	Screw
CD-1350-LC	1.35-1.50	1.250	1.63	3.500	6.780	4.500	2.280	WCMX 06T308-M1(A) or WCGT 06T308-M1	SCR-30	T10	02-03	01-01
CD-1500-LC	1.50-1.65	1.250	1.63	3.500	6.780	4.500	2.280		SCR-30	T10	02-03	01-01
CD-1650-LC	1.65-1.80	1.500	1.88	4.500	8.190	5.500	2.690		SCR-30	T10	02-03	01-02
CD-1800-LC	1.80-1.95	1.500	1.88	4.500	8.190	5.500	2.690		SCR-30	T10	02-03	01-02
CD-1950-LC	1.95-2.10	1.500	N/A	4.500	8.190	5.500	2.690		SCR-30	T10	02-03	01-02
CD-2100-LC	2.10-2.25	1.500	N/A	4.500	8.190	5.500	2.690		SCR-30	T10	02-03	01-02
CD-2250-LC	2.25-2.40	2.000	2.38	5.500	9.750	6.500	3.250		SCR-30	T10	02-03	01-02
CD-2400-LC	2.40-2.55	2.000	N/A	5.500	9.750	6.500	3.250		SCR-30	T10	02-03	01-02
CD-2550-LC	2.55-2.70	2.000	N/A	5.500	9.750	6.500	3.250		SCR-30	T10	02-03	01-02
CD-2700-LC	2.70-2.85	2.000	N/A	6.000	10.250	7.000	3.250		SCR-30	T10	02-03	01-02
CD-2850-LC	2.85-3.00	2.000	N/A	6.000	10.250	7.000	3.250		SCR-30	T10	02-03	01-02
CD-3000-LC	3.00-3.15	2.000	N/A	6.000	10.250	7.000	3.250		SCR-30	T10	02-03	01-02

\*Maximum material removal: WCMX 050308 – 5/16" per side, WCMX 06T308 – 3/8" per side.  
Cartridges can be adjusted 0.075" per side, providing 0.150" adjustment capability on diameter.  
See page 12 for Insert Specifications and Grade Selection.

# WCMX INSERTS

# WCGT INSERTS

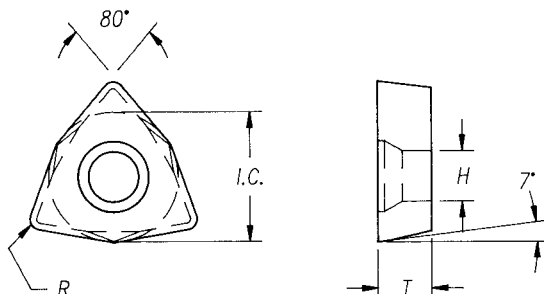
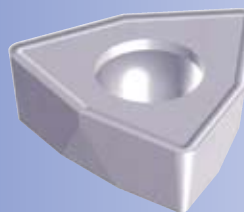

WCMX Inserts				Grades Available							
Insert Number	I.C.	T	R	Cermet	Uncoated Carbide			Coated Carbide			
				6N	10	12	UD11	90C	66C	CD42	PD51
WCMX S30204-M1A*	3/16	0.094	0.016	WCMX Inserts are available in the Grades listed above. See page 3 for complete grade descriptions.							
WCMX 040204-M1A*	1/4	0.094	0.016								
WCMX 050308-M1	5/16	0.125	0.031								
WCMX 050308-M1A*	5/16	0.125	0.031								
WCMX 06T308-M1	3/8	0.156	0.031								
WCMX 06T308-M1A*	3/8	0.156	0.031								

WCMX Inserts are used in Holeshot® and Coremaster™ Drills shown on pages 4-11.

\*M1A suffix denotes Aggressive Chipbreaker.

WCGT Inserts				Grades Available							
Insert Number	I.C.	T	R	Cermet	Uncoated Carbide			Coated Carbide			
				6N	10	12	UD11	90C	66C	CD42	PD51
WCGT 050308-M1	5/16	0.125	0.031	WCGT Inserts are available in the Grades listed above. See page 3 for complete grade descriptions.							
WCGT 06T308-M1	3/8	0.156	0.031								

WCGT Inserts are used in Holeshot® and Coremaster™ Drills shown on pages 4-10.

# OTM STINGER™ DRILLS

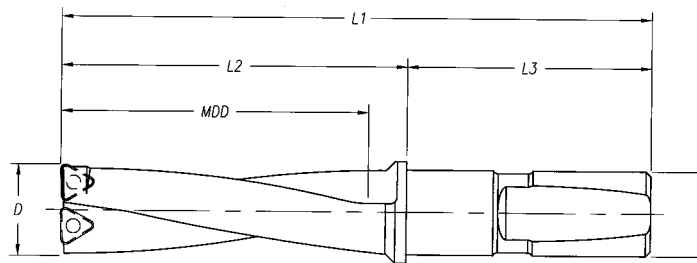

Stinger™ Drills								INCH / METRIC		
Part Number	D	d	MDD	L1	L2	L3	Insert	Qty.	Screw	Wrench
SDR-0484	0.484									
SDR-0492	(0.492) 12.5 mm									
SDR-0500	0.500									
SDR-0512	(0.512) 13 mm									
SDR-0516	0.516	0.500	1.45	3.45	1.95	1.50	TCMT 1.2(1.2)2	2	SCR-07	T6
SDR-0531	0.531									
SDR-0547	0.547									
SDR-0551	(0.551) 14 mm									
SDR-0563	0.563									
SDR-0578	0.578									
SDR-0591	(0.591) 15 mm									
SDR-0594	0.594	0.500	1.63	3.63	2.13	1.50	TCMT 1.2(1.2)2	2	SCR-07	T6
SDR-0609	0.609									
SDR-0625	0.625									
SDR-0630	(0.630) 16 mm									
SDR-0641	0.641									
SDR-0656	0.656	0.500	1.80	3.80	2.30	1.50	TCMT 1.2(1.2)2	2	SCR-07	T6
SDR-0669	(0.669) 17 mm									
SDR-0672	0.672									
SDR-0688	0.688									
SDR-0703	0.703	0.500	1.97	3.97	2.47	1.50	TCMT 1.2(1.2)2	2	SCR-07	T6
SDR-0709	(0.709) 18 mm									
SDR-0719	0.719									
SDR-0734	0.734	0.625	2.16	4.41	2.66	1.75	TCMT 1.8(1.5)2	2	SCR-05	T7
SDR-0748	(0.748) 19 mm									
SDR-0750	0.750									
SDR-0766	0.766									
SDR-0781	0.781	0.625	2.25	4.63	2.75	1.75	TCMT 1.8(1.5)2	2	SCR-05	T7
SDR-0787	(0.787) 20 mm									
SDR-0797	0.797									
SDR-0813	0.813	0.750	2.50	5.03	3.00	2.03	TCMT 1.8(1.5)2	2	SCR-05	T7
SDR-0828	0.828									
SDR-0844	0.844	0.750	2.66	5.19	3.16	2.03	TCMT 1.8(1.5)2	2	SCR-05	T7

See page 16 for Insert Specifications and Grade Selection.

# COUNTERBORES

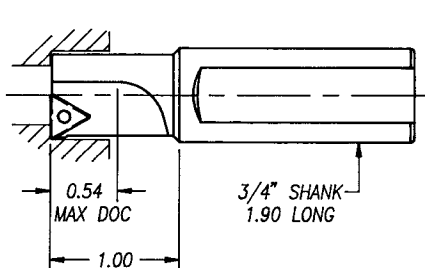

One Flute

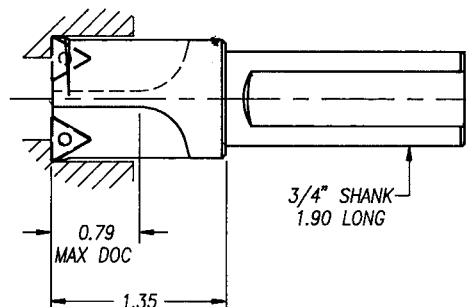

Two Flutes

Counterbores						INCH
Part Number	SHCS Size	Cut Diameter	Flutes	Insert	Screw	Head
1/4-SHCS-CB	1/4"	0.422	1	TCMT 1.8(1.5)1	SCR-05	T7
5/16-SHCS-CB	5/16"	0.515	1			
3/8-SHCS-CB	3/8"	0.609	1			
7/16-SHCS-CB	7/16"	0.703	1			
1/2-SHCS-CB	1/2"	0.797	2			
5/8-SHCS-CB	5/8"	1.000	2			
3/4-SHCS-CB	3/4"	1.187	2			

  

Counterbores						METRIC
Part Number	SHCS Size	Cut Diameter	Flutes	Insert	Screw	Head
M6-SHCS-CB	M6	0.440	1	TCMT 1.8(1.5)1	SCR-05	T7
M8-SHCS-CB	M8	0.558	1			
M10-SHCS-CB	M10	0.676	1			
M12-SHCS-CB	M12	0.755	2			
M16-SHCS-CB	M16	1.000	2			

**NOTE:** Maximum material removal per side is 1/4".

See page 16 for Insert Specifications and Grade Selection.

# COUNTERSINKS

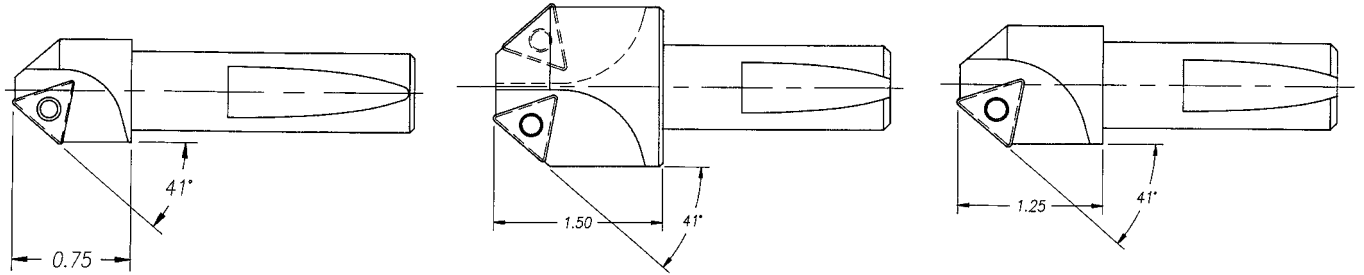

CS-82-177

CS-82-362

CS-82-612

Countersinks									INCH
Part Number	FHCS size(s)	Min Dia	Max Dia	Shank	Eff Flutes	Insert	Qty	Screw	Head
CS-82-177	#10, 1/4, 5/16	0.177	0.673	1/2"	1	TCMT 2(1.5)	1	SCR-01	T7
CS-82-362	3/8, 7/16, 1/2	0.362	1.073	3/4"	1	TCMT 3(2.5)	1	SCR-02	T15
CS-82-612	5/8, 3/4	0.612	1.464	3/4"	1	TCMT 3(2.5)	2	SCR-02	T15

See page 16 for Insert Specifications and Grade Selection.

# TCMT INSERTS

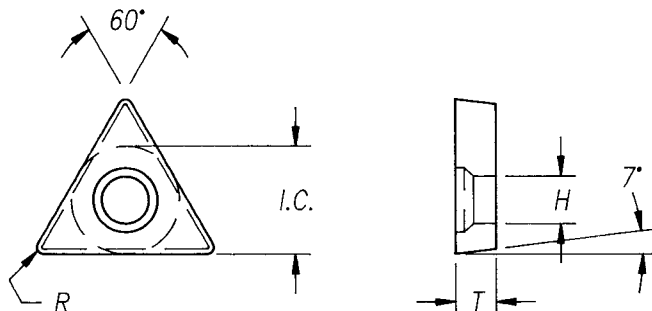
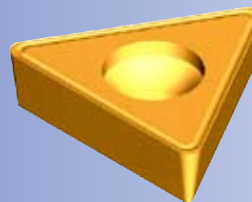

TCMT Inserts				INCH			
Part Number	I.C.	T	R	Grades Available			
				Cermet	Uncoated Carbide	Coated Carbide	
				5N	13	23C	40C
TCMT 1.2(1.2)1	5/32	0.078	0.016				
TCMT 1.2(1.2)2	5/32	0.078	0.031				
TCMT 1.8(1.5)1	7/32	0.094	0.016				
TCMT 1.8(1.5)2	7/32	0.094	0.031				
TCMT 2(1.5)1	1/4	0.094	0.016				
TCMT 2(1.5)2	1/4	0.094	0.031				
TCMT 3(2.5)1	3/8	0.156	0.016				
TCMT 3(2.5)2	3/8	0.156	0.031				

TCMT Inserts are available in the Grades listed above.  
See page 3 for complete grade descriptions.

TCMT Inserts are used in Stinger Drills, Counterbores and Countersinks shown on pages 13-15.